

# VWMB SERIES

## MODULAR MENU BOARD MOUNT

FROM 700 TO 2200 MM

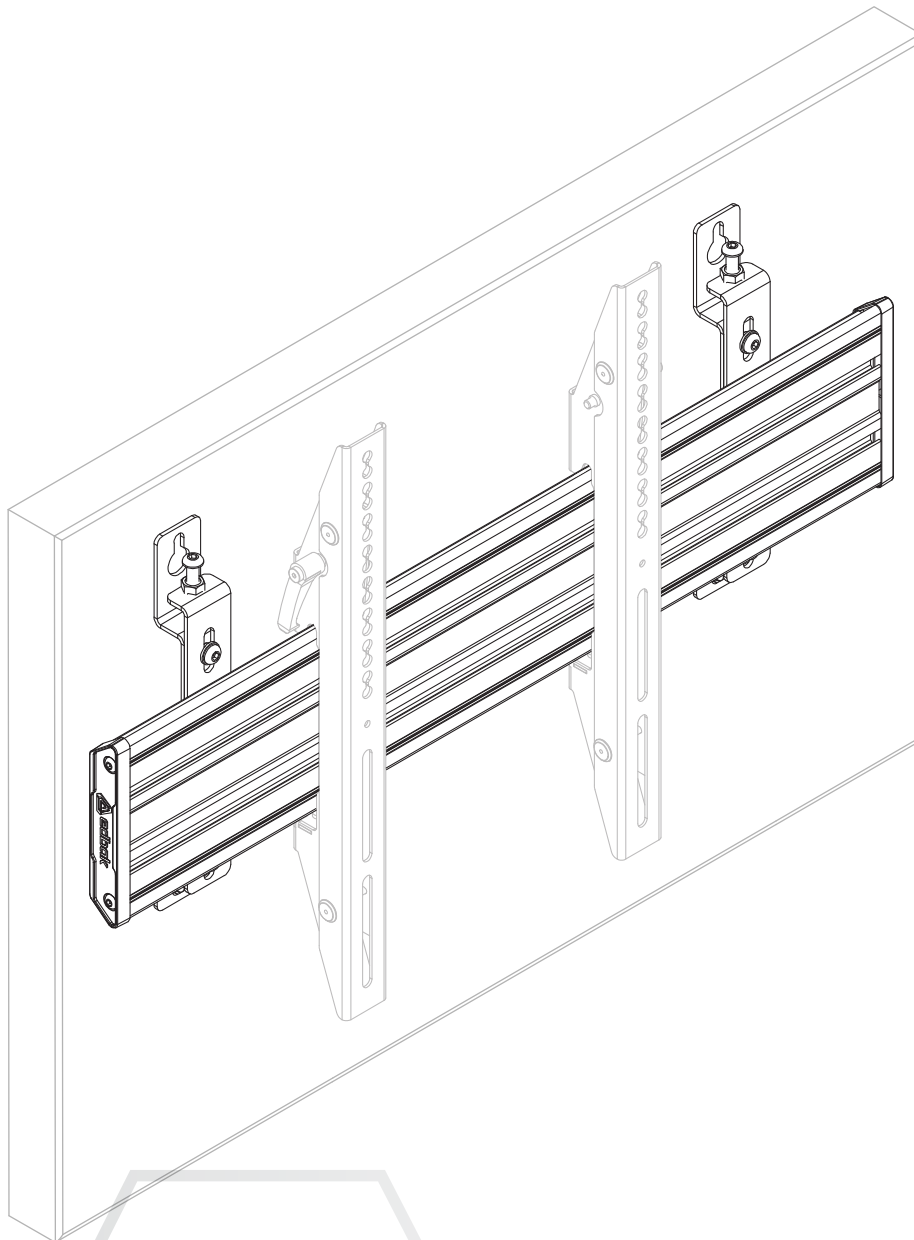

## Warning

Please read this manual before starting the installation to ensure correct assembly.

The assembly should be carried out in accordance with this manual by at least two fully qualified people. The EDBAK Company shall not be liable for any injuries or damage to material or property caused by incorrect assembly. Hence please ensure that:

- during the assembly all the instructions are followed carefully. Failure to do so may result in damage to the product or property, or even personal injury;
- before assembly you must ensure that there are no power cables, or water, sewage or gas pipes in the area of the ceiling where the mount is to be fixed;
- when attaching the projector to the mount, please ensure that the screws are of the correct length and diameter. In order to ensure the correct fit, use the plastic spacers supplied. Use of the wrong screws may result in permanent product damage. Extra caution should be taken with movable parts in order to avoid crushing or pinching your hands or fingers. The movable parts are identified in this manual.

The terms of the product guarantee are detailed in the guarantee card.

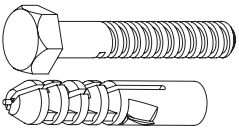
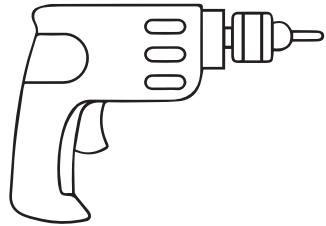
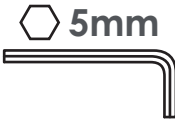
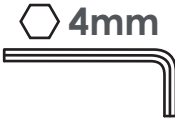
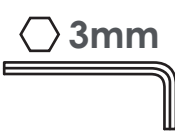

		VWMB700	VWMB970	VWMB1100	VWMB1940	VWMB2200
	<b>AA</b>	4x	4x	4x	6x	6x
	<b>BB</b>	1x				
	<b>CC</b>	1x				
	<b>DD</b>	1x				
	<b>EE</b>	1x				

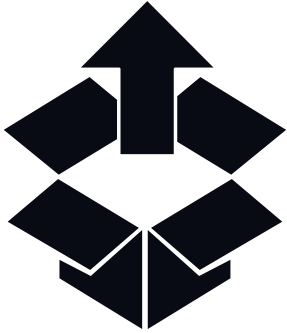

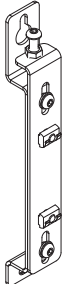
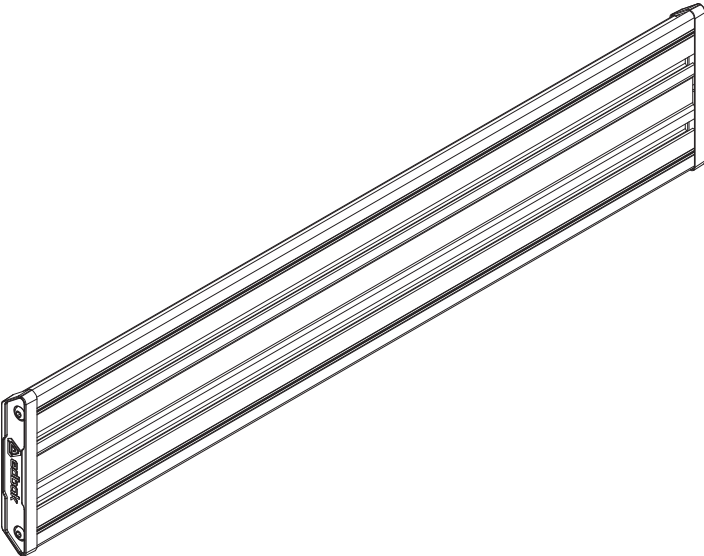
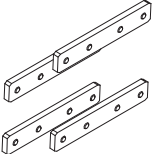
		VWMB700	VWMB970	VWMB1100	VWMB1940	VWMB2200
	<b>A</b>	2x	2x	2x	3x	3x
	<b>B</b>	1x				
	<b>C</b>	1x				

1

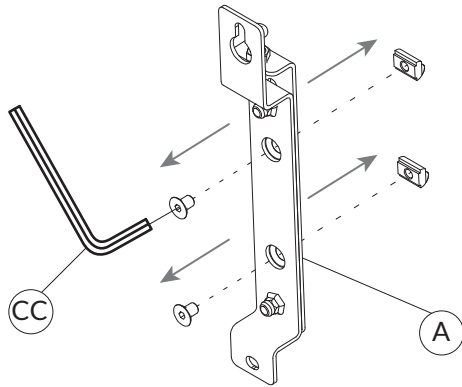

x2: VWMB700, VWMB900, VWMB1100

x3: VWMB1940, VWMB2200

2

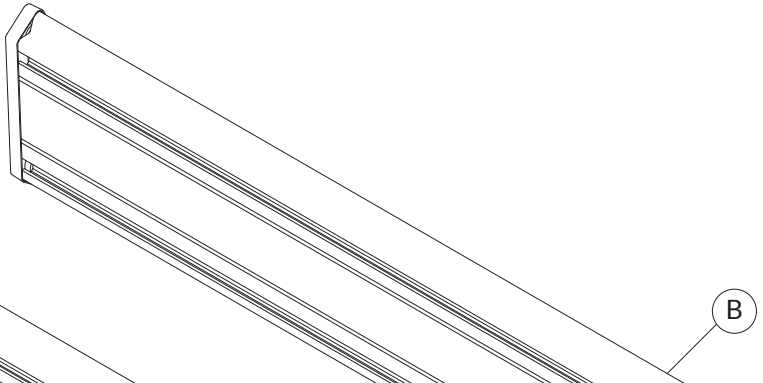

3

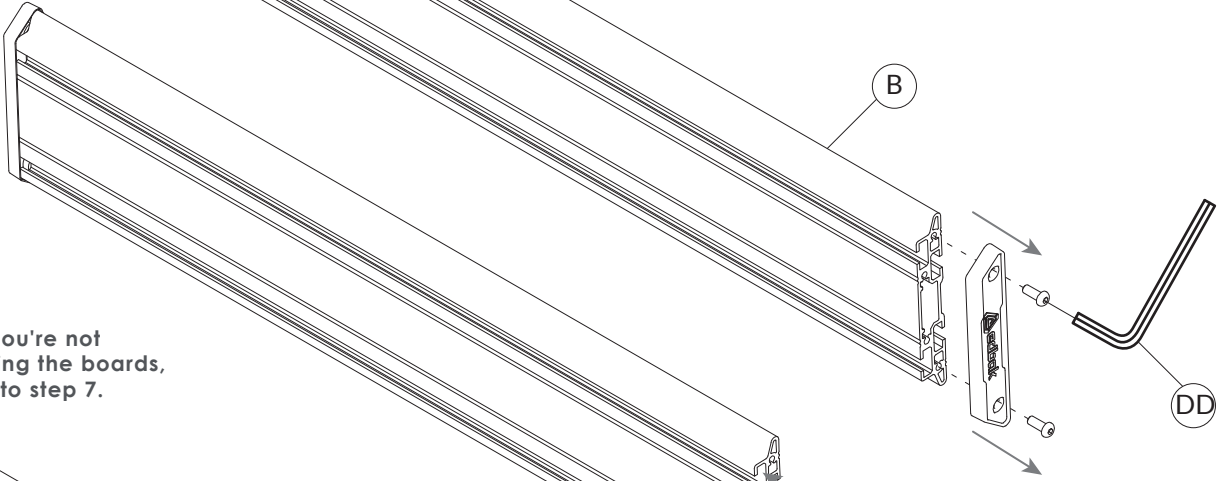

4

If you're not connecting the boards, go to step 7.

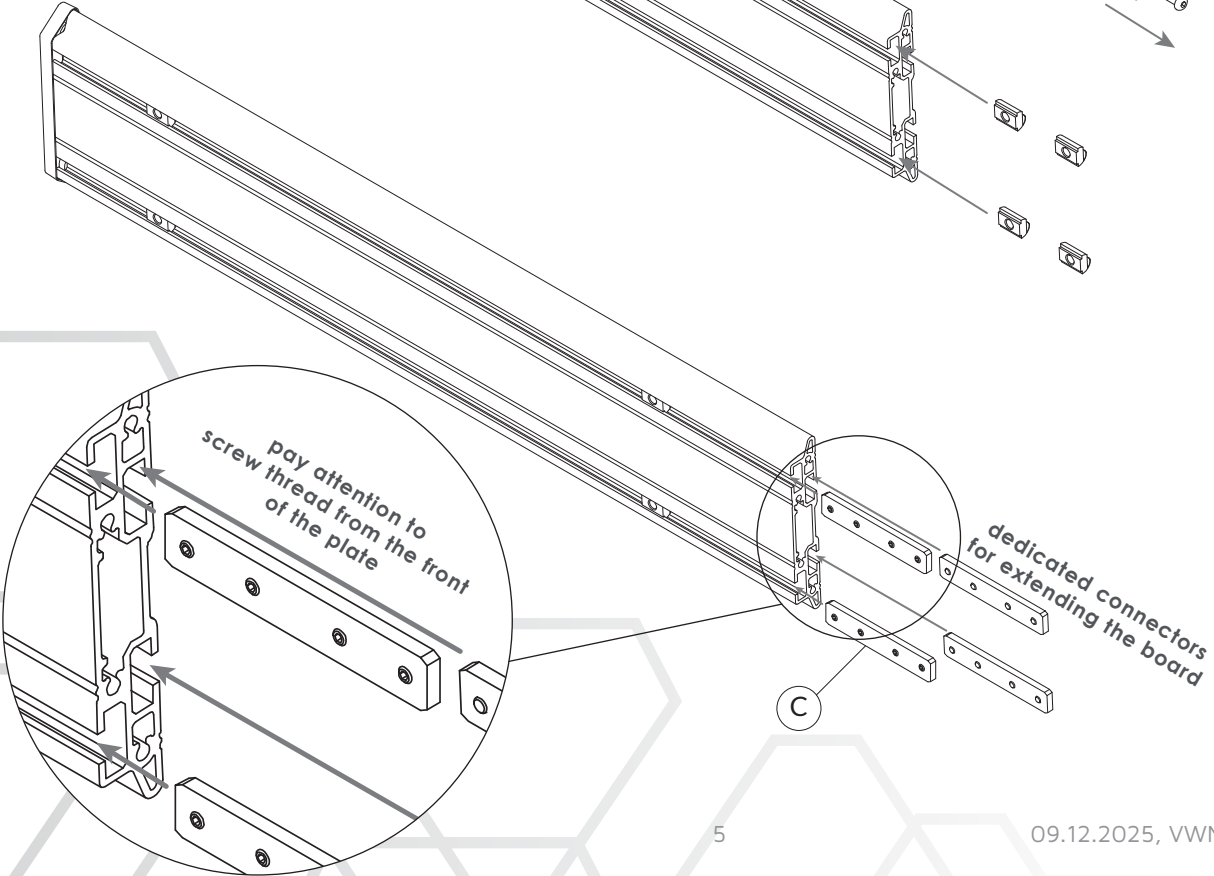

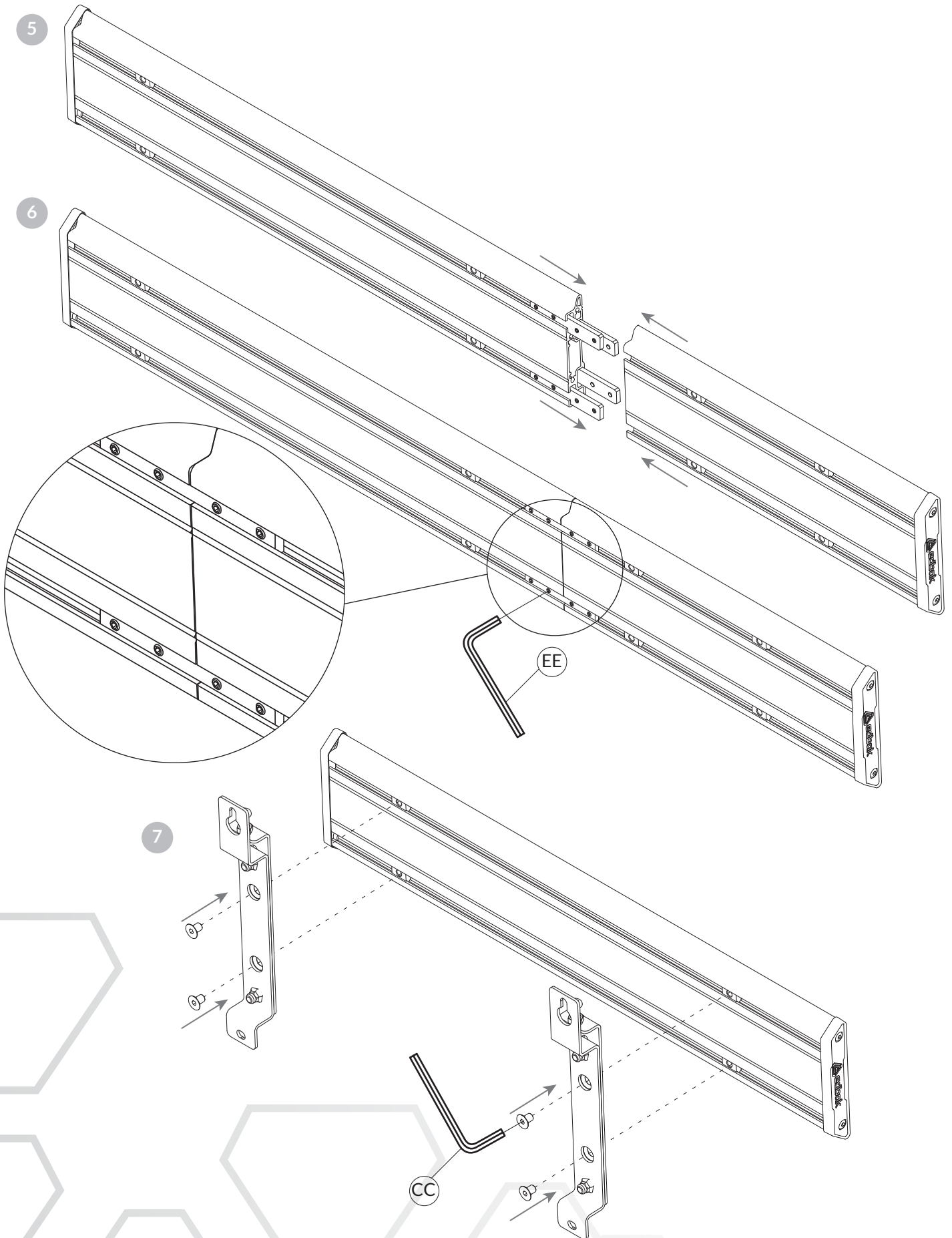

8

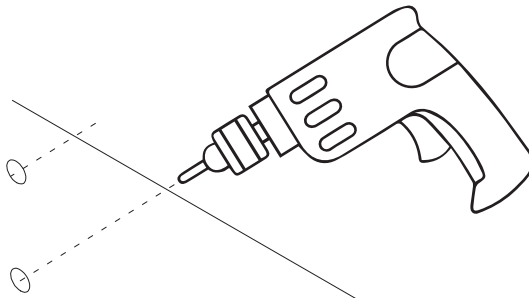

**4 holes:**  
VWMB700, VWMB900, VWMB1100

**6 holes:**  
VWMB1940, VWMB2200

9

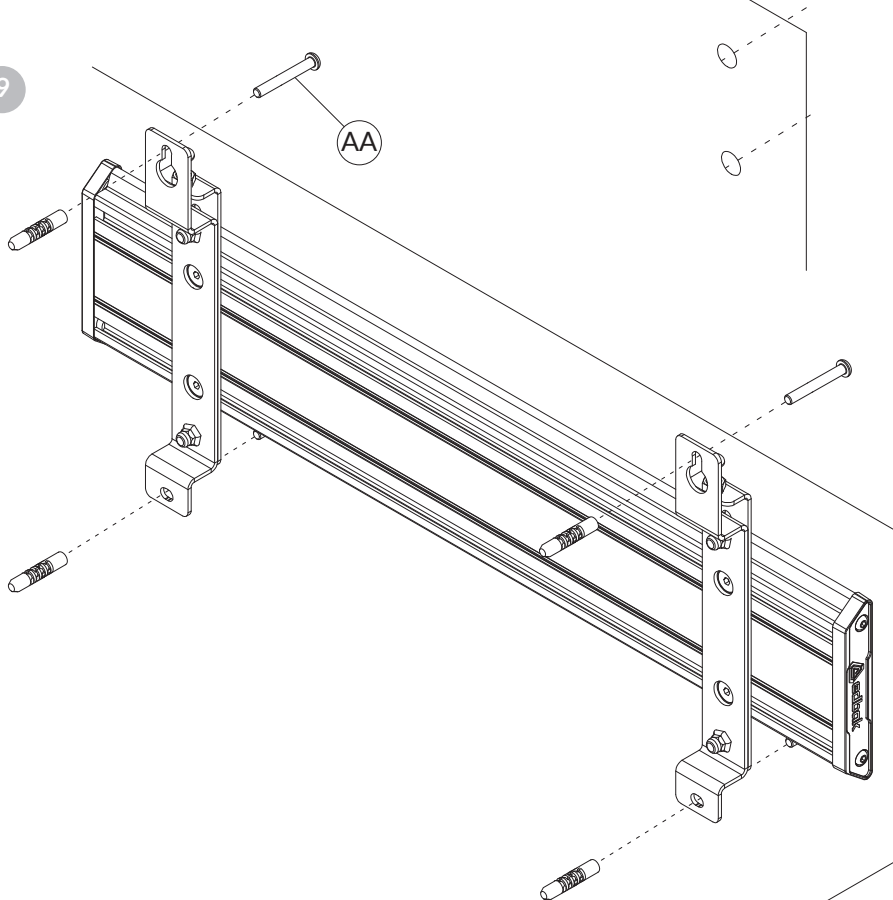

**step 2:**  
set the level with the two  
upper screws

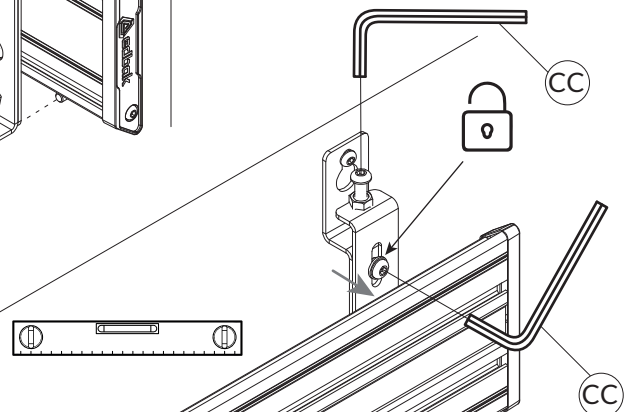

10

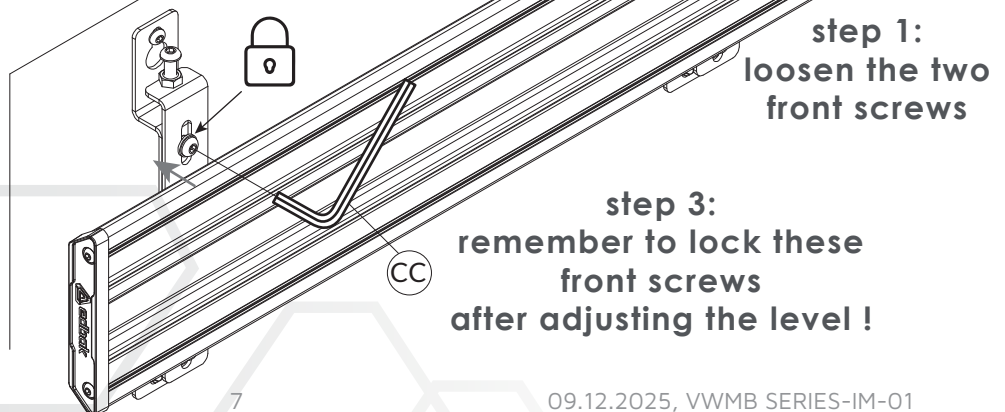

**step 1:**  
loosen the two  
front screws

**step 3:**  
remember to lock these  
front screws  
after adjusting the level !

If you are using VWMPOP.ARMS,  
go to step 13

11

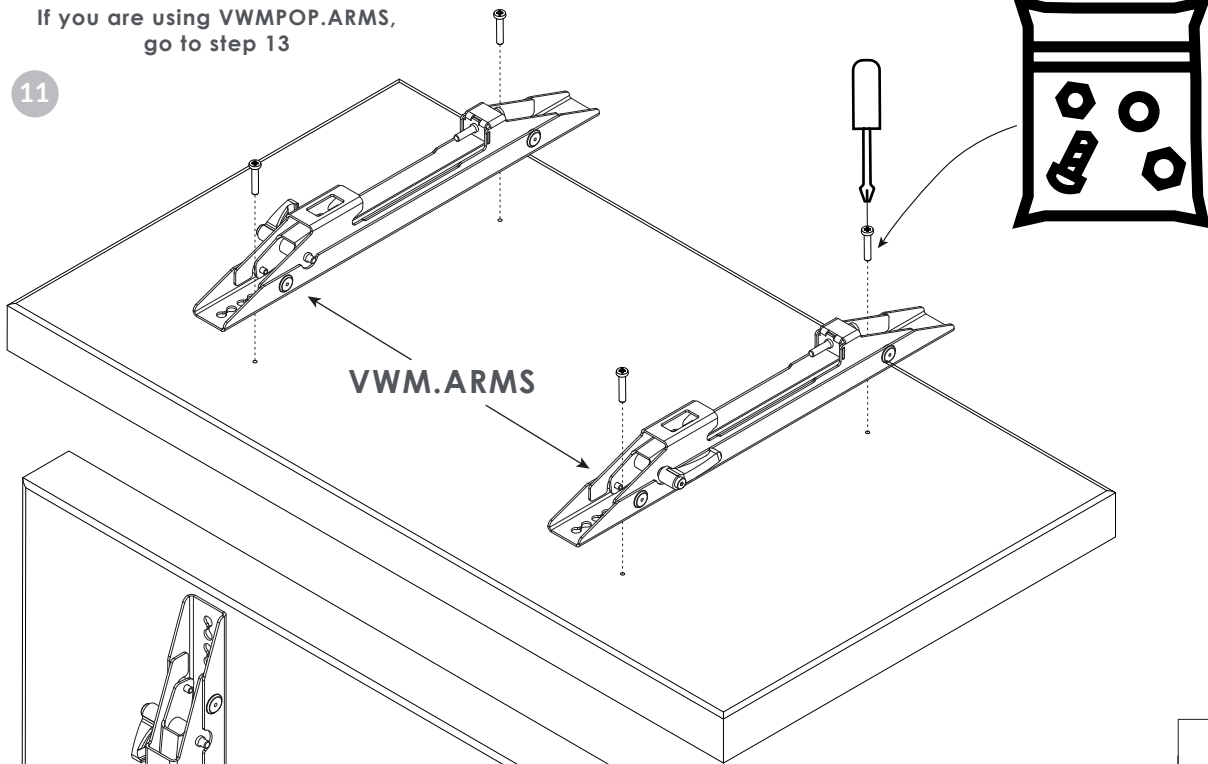

12

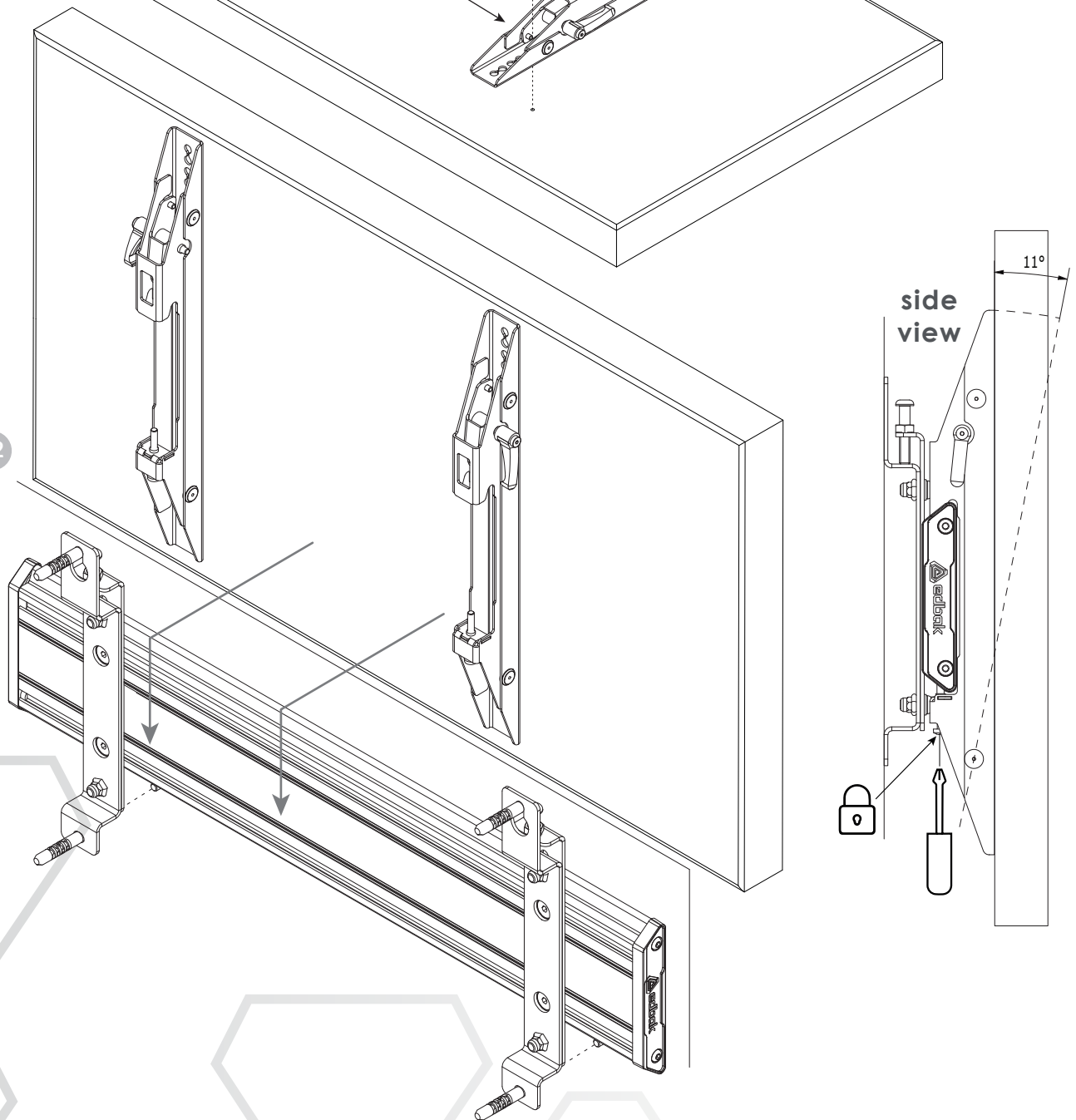

13

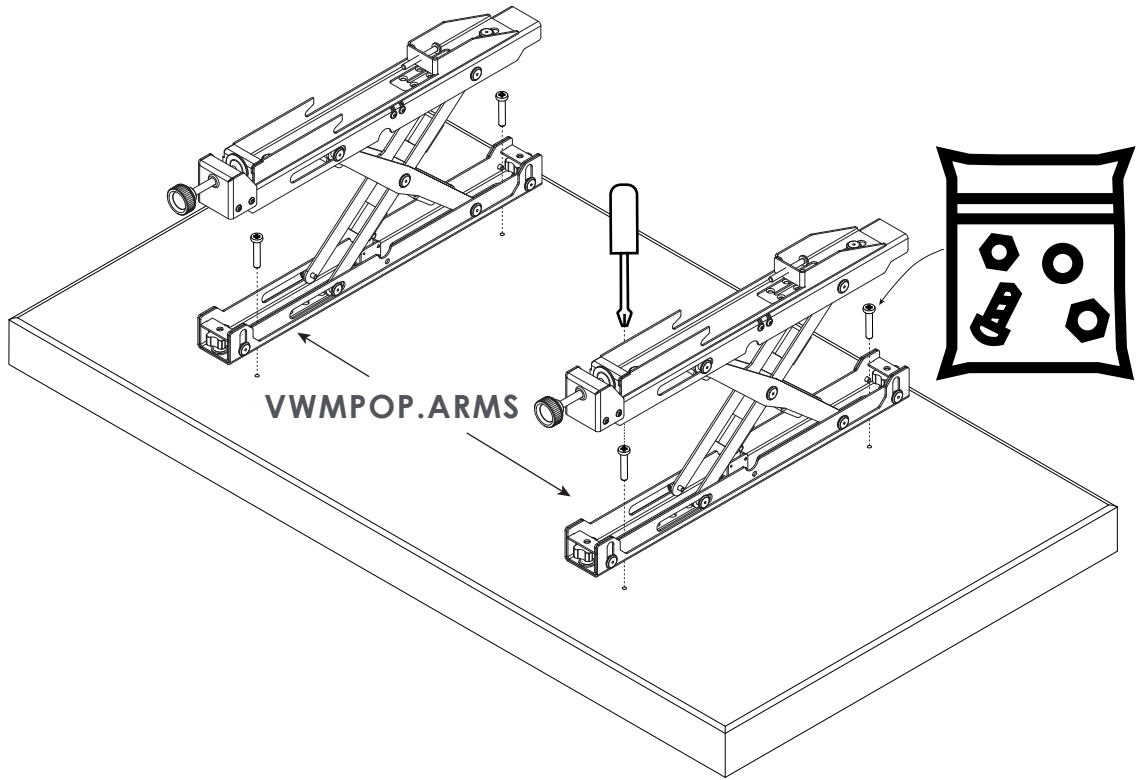

14

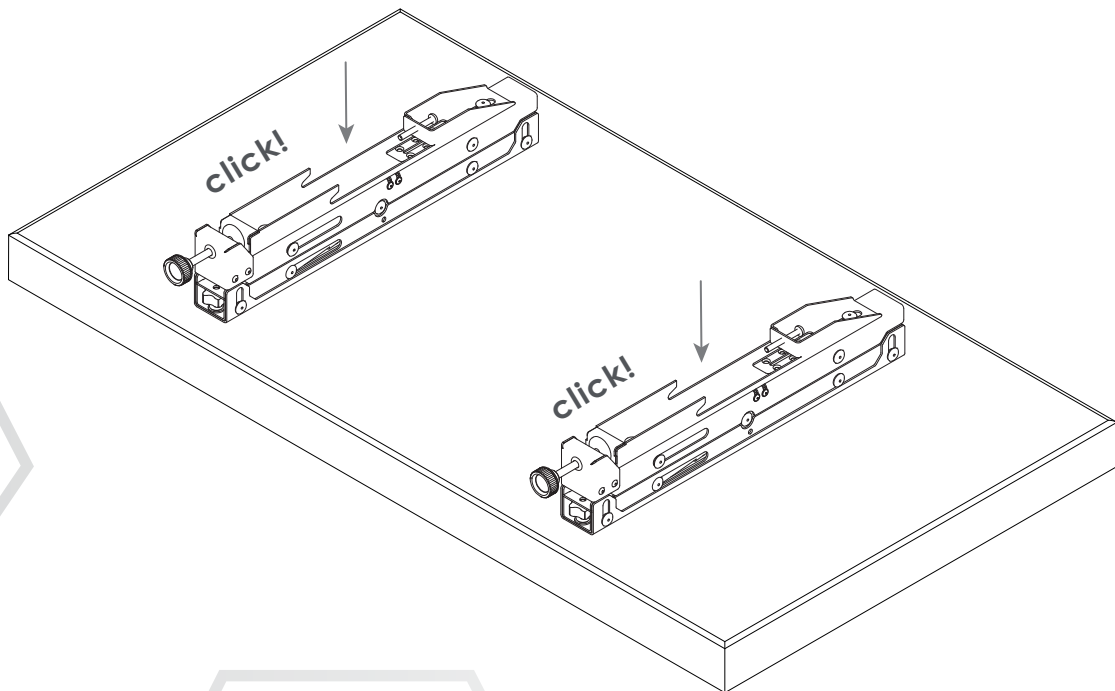

15

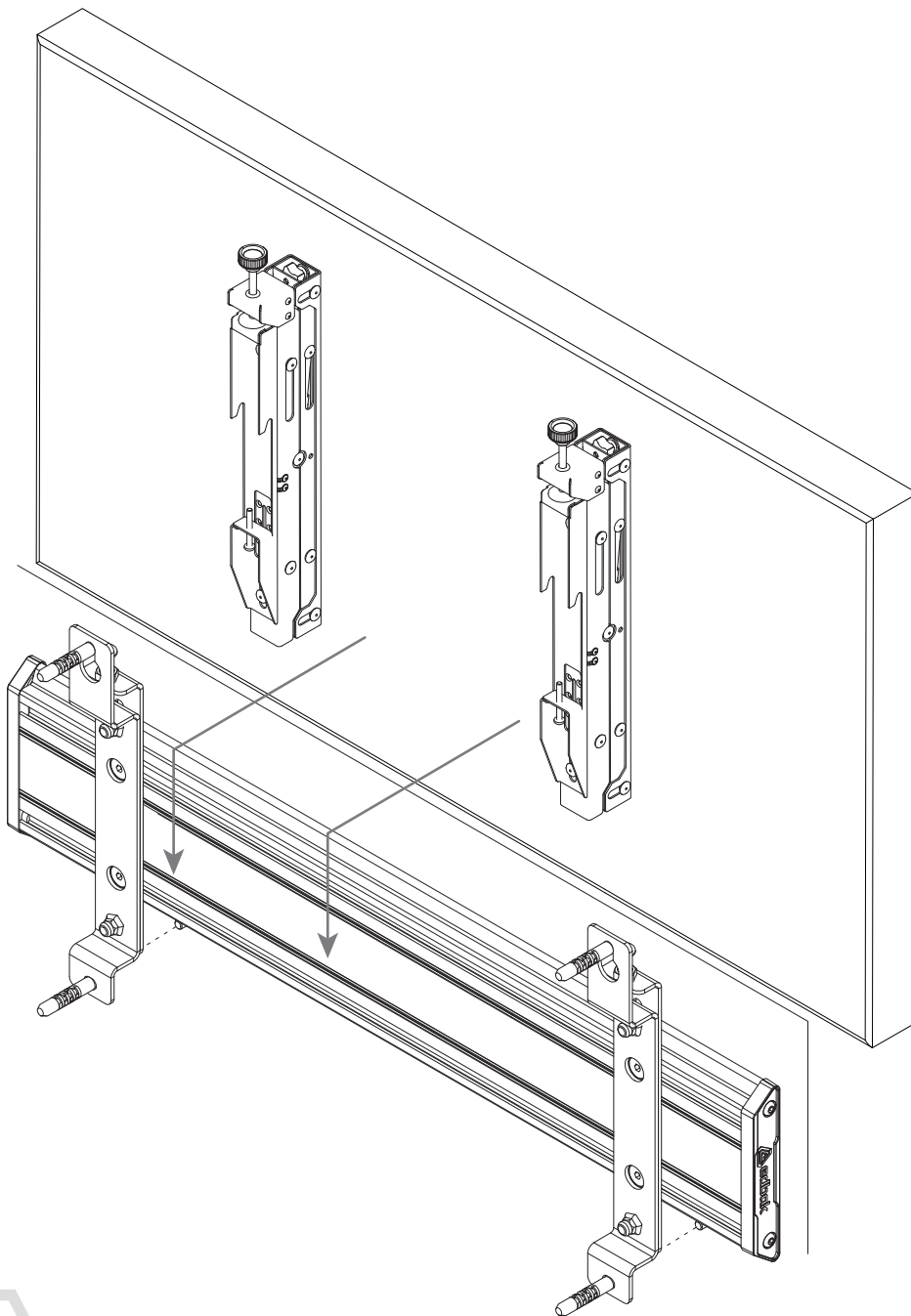

side view

