

Wallplate (WP) TPS Extender for Single CATx Cable with PoE



Wallplates



WP-HDMI-TPS-RX97-US

Part No: 9154 0035 (TX), 9154 0029 (RX)



WP-HDMI-TPS-RX97-EU

Part No: 9154 0033 (TX), 9154 0027 (RX)



WP-HDMI-TPS-RX97-UK

Part No: 9154 0034 (TX), 9154 0028 (RX)

Floorplates



FP-HDMI-TPS-RX97-CRFB

Part No: 9154 0049 (TX), 9154 0048 (RX)



FP-HDMI-TPS-RX97-Legrand

Part No: 9154 0038 (TX), 9154 0032 (RX)



FP-HDMI-TPS-RX97-GB3

Part No: 9154 0037 (TX), 9154 0031 (RX)





Features

- 4K UHD HDBase™ compatible HDMI TPS extender wallplates and floorpanels
- Single-Link DVI and HDMI extension supporting 4K/UHD (30Hz RGB 4:4:4, 60Hz YCbCr 4:2:0) and 120 Hz 3D capabilities
- Extends Single-Link DVI or HDMI + Ethernet + RS-232 + IR over one CATx cable up to 170m* transmission distance over TPS
- 10/100 Ethernet transmission
- Bi-directional RS-232 and IR
- HDCP compliant, CEC, EDID transparent
- Operation mode switch (Auto or forced Long Reach Mode)
 - The auto operation mode allows the device to detect the far end extender's mode and adopt it.
- New design fits standard wall and floor panel boxes while providing optimized cable connect and removal
- Fits in most common standard wall and floor panel boxes

*Depends on cable category and quality

Applications

- Post production studios
- Control room
- Digital Signage
- Multiroom video
- Conference rooms, collaborative telepresence

The following table lists additional versions of the same wall and floor panel series. For availability and other information please inquire at your Lightware sales contact.

	Product variants	Part Numbers
Wallplates	WP-HDMI-TPS-RX97-EU	9154 0027
	WP-HDMI-TPS-RX97-US	9154 0029
	WP-HDMI-TPS-RX97-UK	9154 0028
	WP-HDMI-TPS-TX97-EU	9154 0033
	WP-HDMI-TPS-TX97-US	9154 0035
	WP-HDMI-TPS-TX97-UK	9154 0034
	Floor panels	FP-HDMI-TPS-RX97-GB3
FP-HDMI-TPS-RX97-LEGRAND		9154 0032
FP-HDMI-TPS-RX97-CRFB		9154 0048
FP-HDMI-TPS-TX97-GB3		9154 0037
FP-HDMI-TPS-TX97-LEGRAND		9154 0038
FP-HDMI-TPS-TX97-CRFB		9154 0049

WP/FP-HDMI-TPS-TX/RX97 series twisted pair HDBase™ extenders provide extension of uncompressed 4K/UHD video with embedded audio (up to eight channel PCM or HBR audio) for long distances over a single CATx cable.

The thoroughly redesigned form factor of the wall and floor panels allows for easier connecting and removing cables in narrow spaces (behind TV sets, under floor panel lids) and reduces cable bending and breaking. The built-in cable tie-down points further ensure stable connection and reduce cable stress.

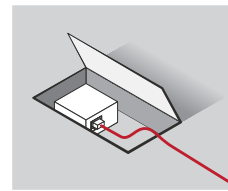

Cable access example with Floorbox extender

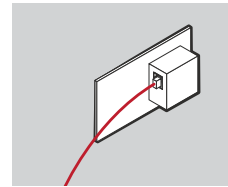

Cable access and orientation example with wall plate extenders.

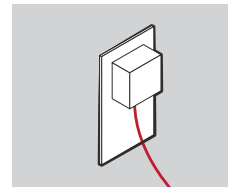

Cable access and orientation example with wall plate extenders.

Specification

Data rate:	3.4 Gbps per color
Resolution:	All HDMI 1.4a resolutions supported
Equalization:	Adaptive, automatic
EDID support:	Transparent
HDCP pass through:	Yes
Ethernet pass-through:	Yes
RS-232 pass through:	Yes
IR pass through:	Yes
Overall signal delay:	10µs (including 100m CATx cable)
Power:	Universal power adaptor, DC 48V 0.5 A
Power consumption (-TX):	3.6 W (typ) 4.2 W (max)
Power consumption (-RX):	5.3 W (typ) 6.1 W (max)
Enclosure:	1 mm metal
Dimensions:	100.4 W x 100.4 D x 26 H mm
Weight:	330 g / product
Compliance:	CE
Warranty:	3 years

Port Diagram

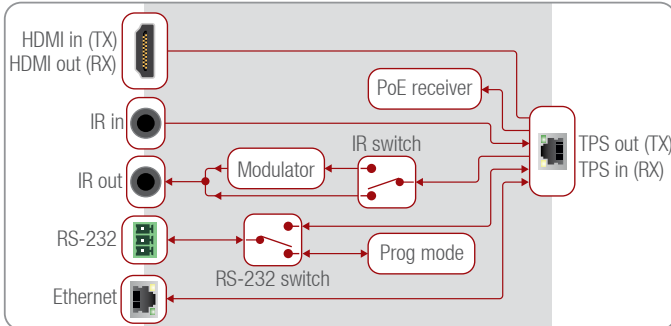

Connectors

TX input, RX output:	HDMI connector
TX output, RX input:	RJ45 (TPS interface)
Ethernet:	RJ45
IR In, out:	3.5mm TRS connector (1/8" mini-jack)
Serial port:	9-pole D-sub
Power:	Locking DC connector (2.1 / 5.5 mm)

Max Cable Lengths with the Available Operation Modes

Resolution	Pixel Clock Rate	Cable Lengths (Auto / LR Link Mode)		
		CAT5e AWG24	CAT7 AWG26**	CAT7 AWG23
1024x768@60Hz	65 MHz	100 m / 130 m*	90 m / 120 m*	120 m / 170 m*
1280x720@60Hz	73,8 MHz	100 m / 130 m*	90 m / 120 m*	120 m / 170 m*
1920x1080p@60Hz / 24bpp	148,5 MHz	100 m / 130 m*	90 m / 120 m*	120 m / 170 m*
1920x1200@60Hz	152,9 MHz	100 m / NA*	90 m / NA*	120 m / NA*
1600x1200@60Hz	162 MHz	100 m / NA*	90 m / NA*	120 m / NA*
1920x1080@60Hz / 36bpp	223,6 MHz	70 m / NA*	70 m / NA*	100 m / NA*
3840x2160@30Hz UHD	297 MHz	70 m / NA*	70 m / NA*	100 m / NA*
4096x2160@30Hz 4K	297 MHz	70 m / NA*	70 m / NA*	100 m / NA*

* with Long reach operation mode which supports pixel clock frequencies up to 148,5 MHz.

** when remote powering is used with AWG26 cables, distances are 20% shorter.

WP-HDMI-TPS-RX97, WP-HDMI-TPS-TX97, FP-HDMI-TPS-RX97, FP-HDMI-TPS-TX97

WP-HDMI-TPS-TX97 Standalone Application

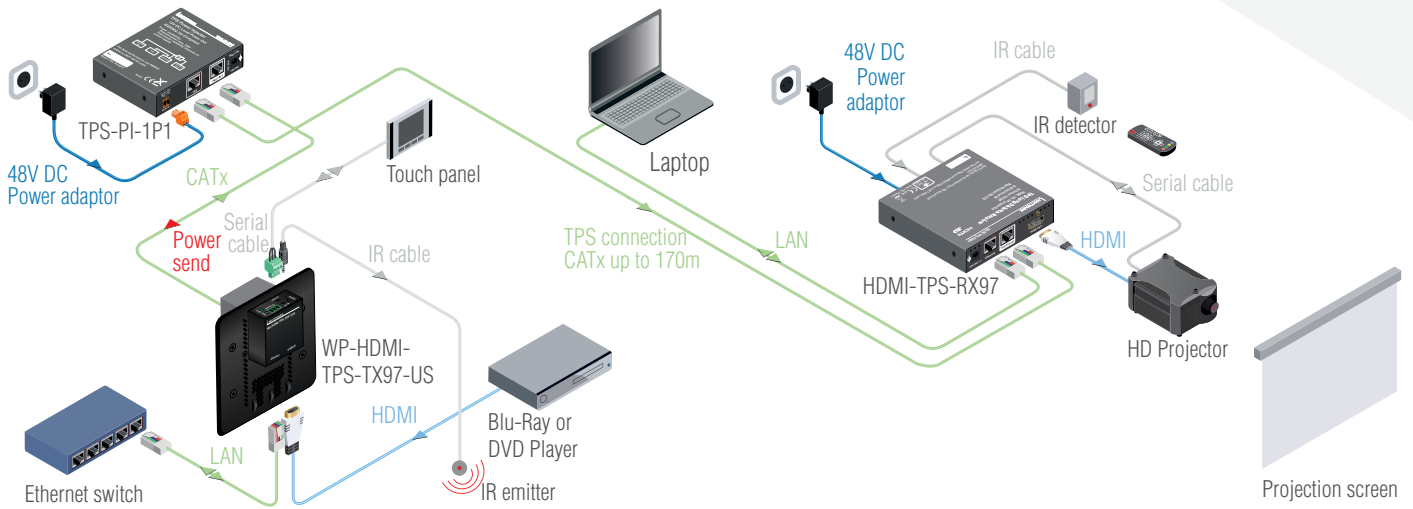

WP-HDMI-TPS-RX97 Standalone Application

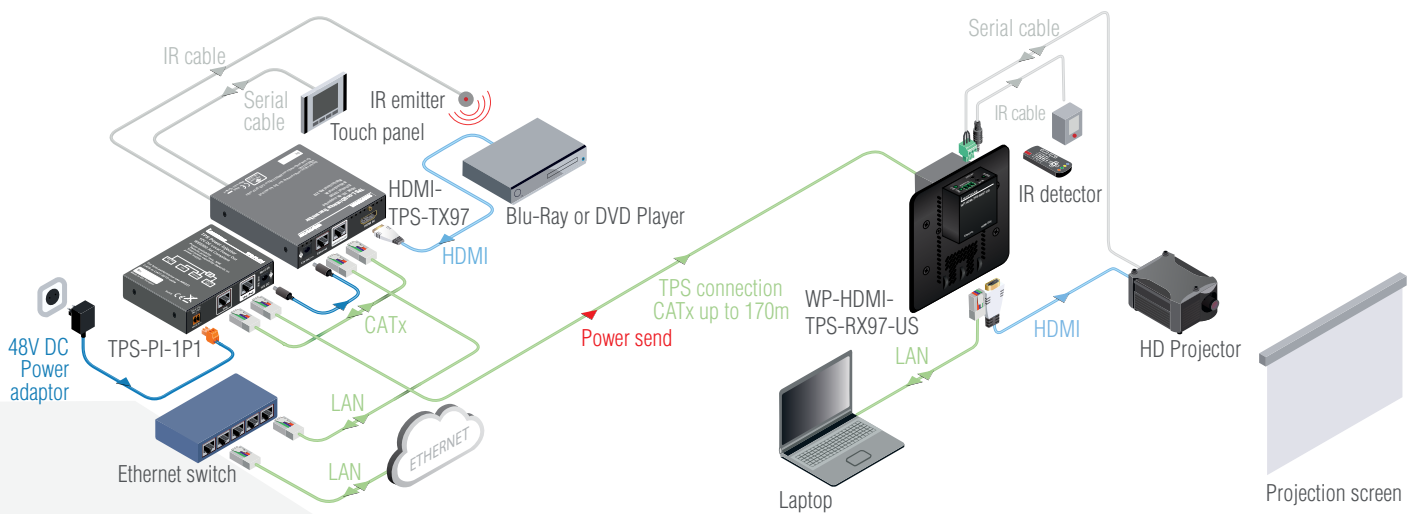

HDBaseT™ and the HDBaseT Alliance logo are trademarks of the HDBaseT Alliance

FP-HDMI-TPS-TX97 Application with Matrix

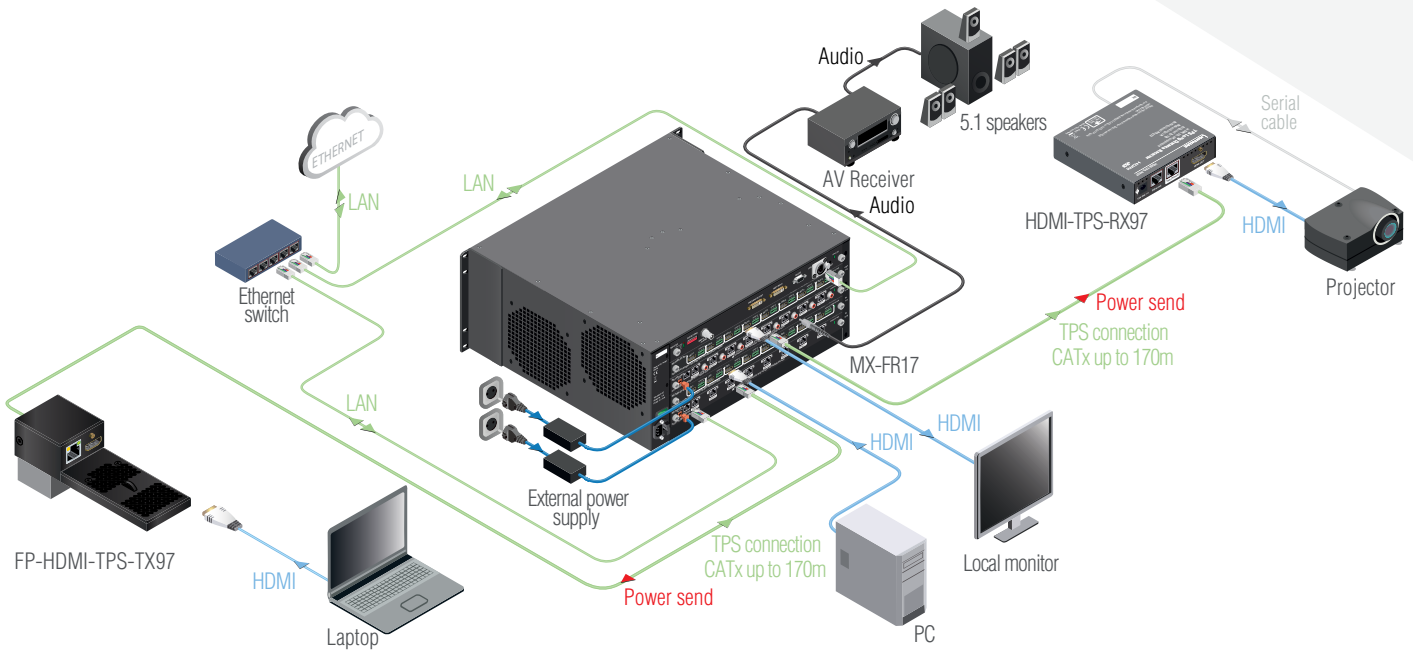

FP-HDMI-TPS-RX97 Application with Matrix

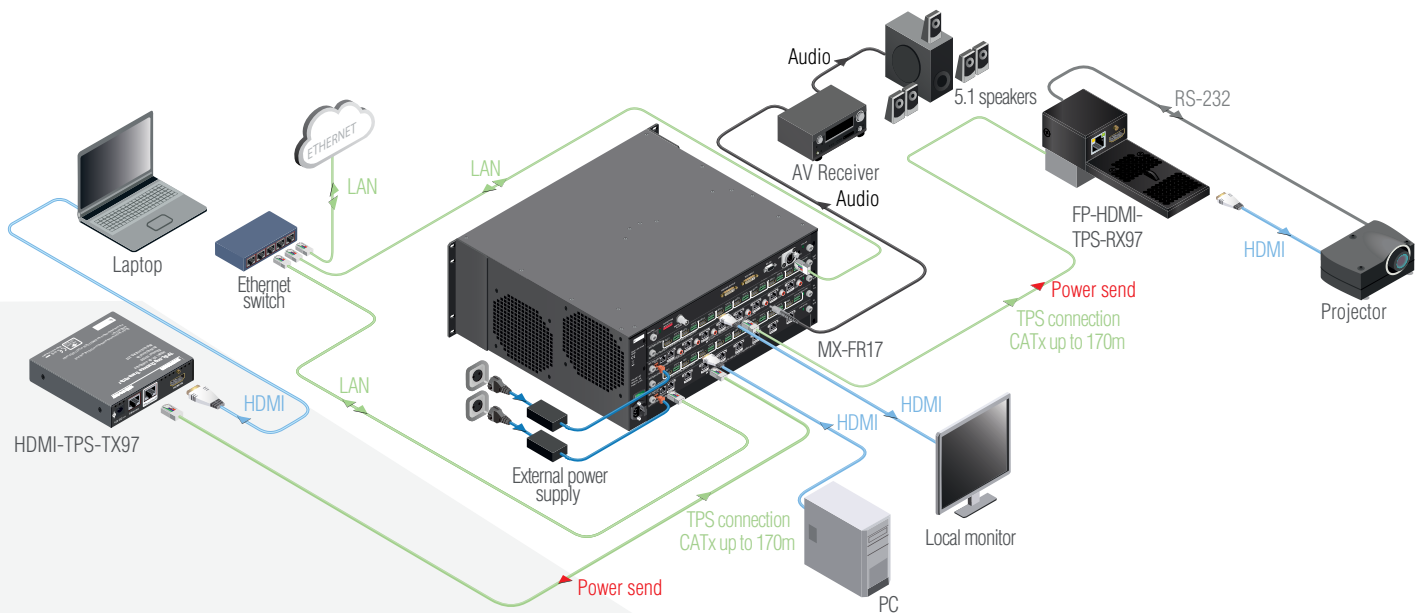

HDBaseT™ and the HDBaseT Alliance logo are trademarks of the HDBaseT Alliance